

MODEL DFI664**FEATURES**

Accepts custom panel and handle to integrate with surrounding cabinetry

Hidden controls

Turbo Drying™ system

16 place-setting capacity

Quiet operation – 42 dB(A)

9Spray™ wash system; separate spray nozzles clean pots & pans and continuously spray the cutlery basket

11 wash programs

Delayed start – up to 24 hours

Heavy-duty stainless steel construction with nylon-coated steel racks

Status light

ADA height compliant

Accommodates 4" or 6" toe kick height (6" requires 34½" minimum opening height)

ACCESSORIES

Stainless steel front panel with tubular or pro handle

Stainless steel tubular and pro handles

Accessories available through an authorized Asko dealer. For local dealer information, visit the find a showroom section of our website, askona.com.

**INTERIOR FEATURES**

- Top tray with Instant Lift™
- Premium upper rack
- Premium lower rack

PROGRAMS

- Sanitation Wash
- Normal Wash
- Eco Wash
- Rinse and Hold
- Time Program
- Plastic Wash
- Hygiene Wash
- Crystal Glass
- Self-Cleaning
- Lower Half Wash
- Upper Half Wash

PRODUCT SPECIFICATIONS

| | |
|-------------------------------|---|
| Model | DFI664 |
| Width | 23 ⁵ / ₈ " |
| Height | 32 ³ / ₄ "** – 34 ³ / ₄ " |
| Depth | 22" |
| Door Clearance | 24 ⁵ / ₈ " |
| Weight | 112 lb |
| Max Loading Height Upper Rack | 9" |
| Max Loading Height Lower Rack | 13 ⁷ / ₈ " |
| Electrical Supply | 115 VAC, 60 Hz |
| Electrical Service | 15 amp circuit |
| Plumbing Supply | 1/4" OD copper, braided stainless steel or PEX tubing |
| Pressure | 4.2–140 psi |

Product dimensions do not include panel and handle.
Dimensions will vary with panel thickness.

Electrical supply, plumbing supply and drain should be located in an adjacent cabinet. If not, they must be located within the shaded area shown in the illustrations below.

ELECTRICAL | PLUMBING

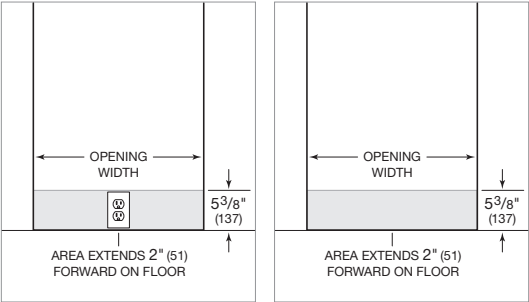

DIMENSIONS

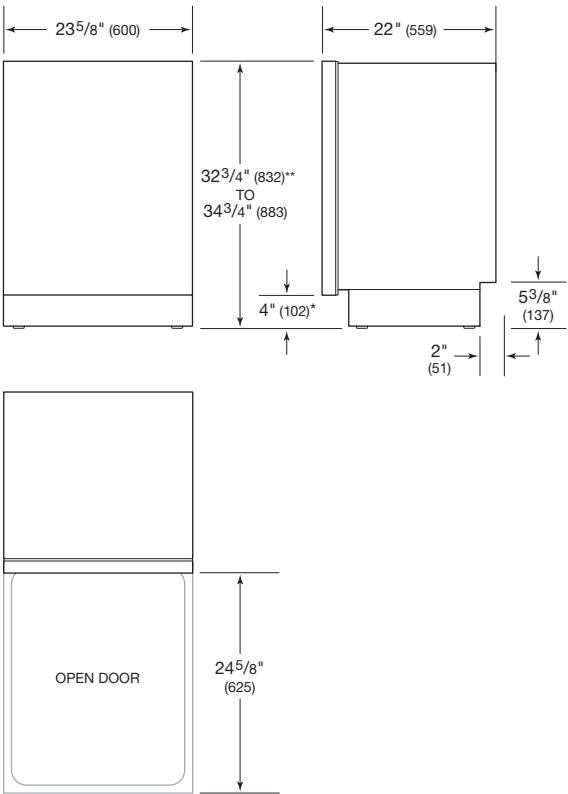

*Dimension will vary with product height.
**Can be reduced to 32¹/₄" (819).

INSTALLATION

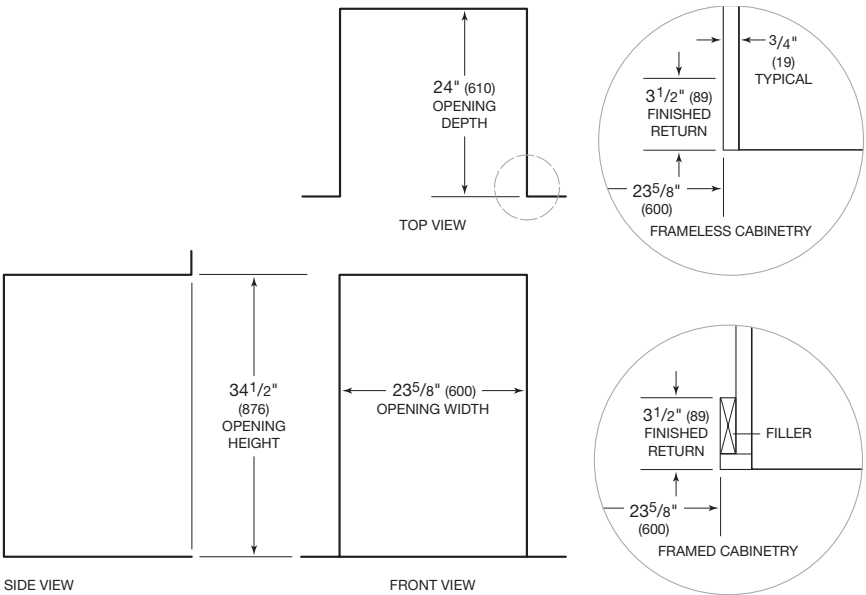

NOTE: 3 1/2" (89) finished returns will be visible and should be finished to match cabinetry.