

# HUF13STR

Hotpoint® 13.0 Cu. Ft. Frost-Free Upright Freezer

## DIMENSIONS AND INSTALLATION INFORMATION (IN INCHES)

FRONT VIEW

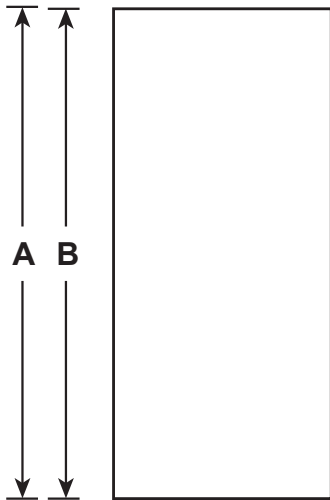

TOP VIEW

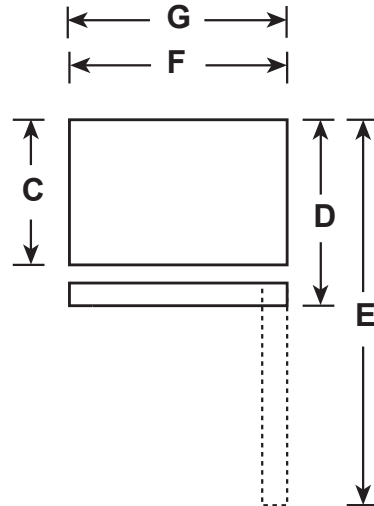

OVERALL DIMENSIONS	Height to top of hinge (in.) <b>A</b>	<b>65</b>
	Height to top of case (in.) <b>B</b>	<b>64-1/2</b>
	Case depth without door (in.) <b>C</b>	<b>23</b>
	Case depth no handle (in.) <b>D</b>	<b>26-1/2</b>
	Depth with door open 90° (in.) <b>E</b>	<b>52</b>
	Width (in.) <b>F</b>	<b>27-4/5</b>
	Width with door open 90° no handle (in.) <b>G</b>	<b>29</b>
AIR CLEARANCES	Each side (in.)	<b>3</b>
	Top (in.)	<b>3</b>
	Back (in.)	<b>2</b>

**Hotpoint**®

For answers to your Monogram, GE Café™, GE Profile™ or GE Appliances product questions, visit our website at [geappliances.com](http://geappliances.com) or call GE Answer Center® Service, 800.626.2000.

# HUF13STR

## *Hotpoint® 13.0 Cu. Ft. Frost-Free Upright Freezer*

### **FEATURES AND BENEFITS**

Total Capacity: 13.0 Cu. Ft.

ADA Compliant: Yes

Energy Star: No

Door Swing: Right

Door Exterior Style: High Gloss Smooth Steel

Shelves: Glass

Control Type: Interior Electronic

Internal Lighting: LED

Colors Available: White

Case Color: Textured Steel, White

Warranty: Limited 1-year entire appliance

Model HUF13STRWW - White

